

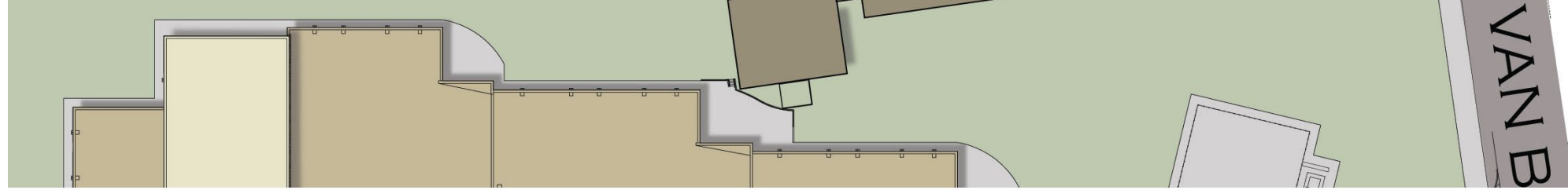

Groves Middle School - Site Plan



● Light poles on concrete bases

● Soffit lighting at all canopies

Exterior lighting provided on building and at all exterior doors

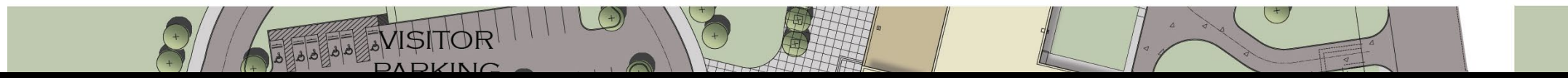
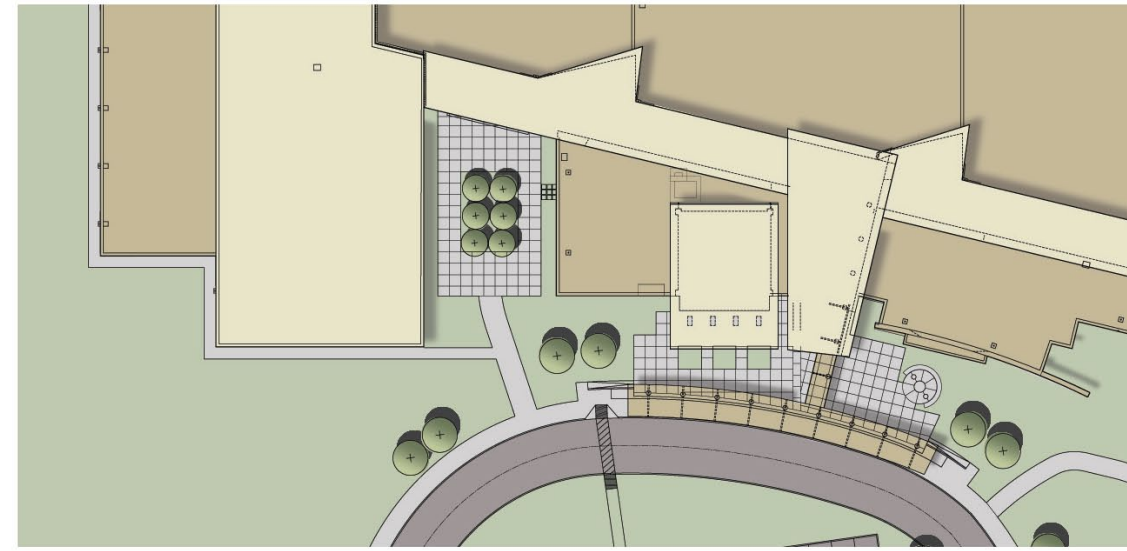
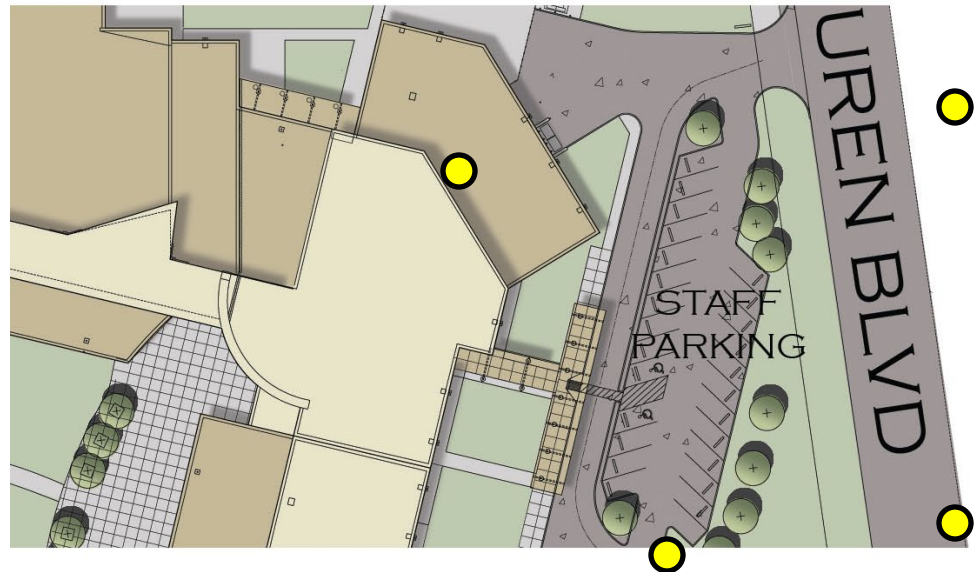
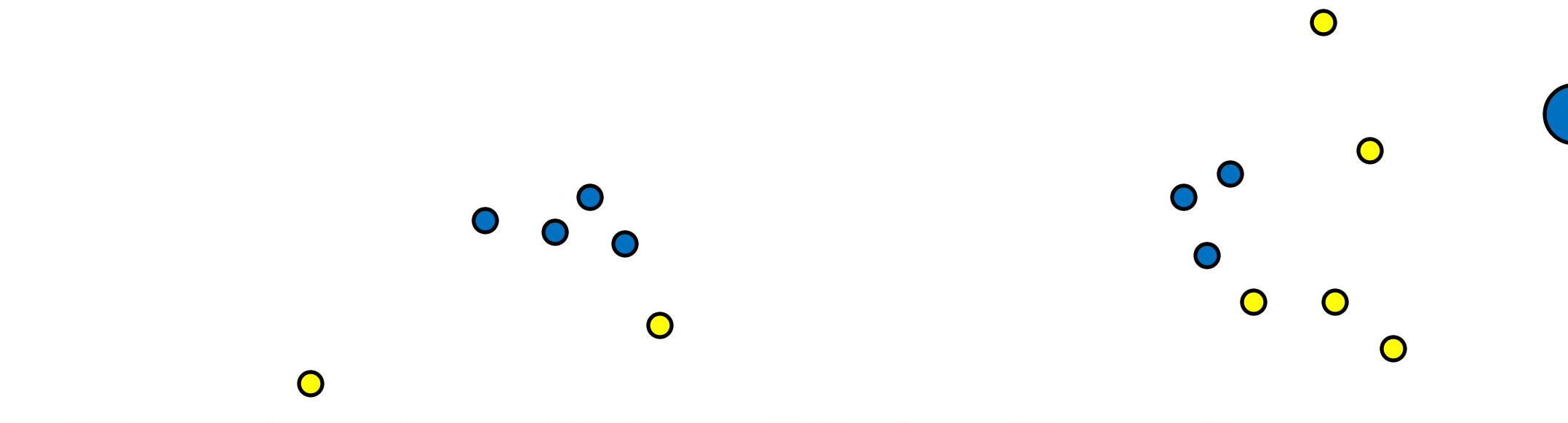

Groves Middle School - Site Plan

- Exterior lighting allowance of \$80,000 was built into project.
- Scope is defined and priced by this Proposal Request / Allowance Expenditure Authorization
- Total cost is \$85,647.10
 - Lighting allowance will be charged \$80,000
 - Contingency allowance will be charged \$5,647.10